

Spec Sheet

Metal Core SMD Power Inductors for Automotive / Industrial Applications (MCOIL™, MD series)

MDMK2020T2R2MMV

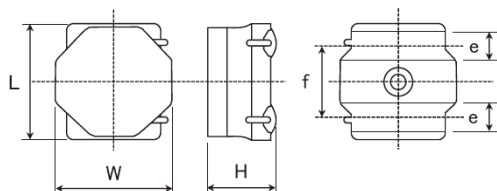

■ Features

- Item Summary
2.2uH±20%, 1.45A, 2.0x2.0x1.2mm
- Lifecycle Stage
Mass Production
- AEC-Q200 qualified
- Standard packaging quantity (minimum)
Taping Embossed 2500pcs

■ Products characteristics table

Inductance	2.2 uH ± 20 %
Case Size (mm)	2.0x2.0
Rated Current (max)	1.45 A
Saturation Current (max)	1.75 A
Saturation Current (typ)	2 A
Temperature Rise Current (max)	1.45 A
Temperature Rise Current (typ)	1.55 A
DC Resistance (max)	109 mΩ
DC Resistance (typ)	95 mΩ
LQ Measuring Frequency	1 MHz
Operating Temp. Range	-40 to +125 °C (Including-self-generated heat)
Temperature characteristic (Inductance change)	± 10 %
RoHS2 Compliance (10 subst.)	Yes
REACH Compliance (173 subst.)	Yes
Halogen Free	Yes
Soldering	Reflow

■ External Dimensions

Dimension L	2.0 ±0.15 mm
Dimension W	2.0 ±0.15 mm
Dimension H	Max 1.2 mm
Dimension e	0.5 ±0.2 mm
Dimension f	1.25 ±0.2 mm

■ Recommended Land Patterns

【推奨ランドパターン】
実装上の注意
・実装状態を確認の上ご使用ください。また、ご購入の際は、本製品のハンダ付けはリフローハンダ工法に限りません。

【Recommended Land Patterns】
Surface Mounting
・Mounting and soldering conditions should be checked beforehand.
・Applicable soldering process to these products is reflow soldering only.

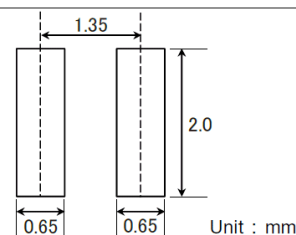

The data is reference only. Electrical characteristics vary depending on environment or measurement condition. TAIYO YUDEN reserves the right to make change to the Date at any time without notice. Before making final selection, please check product specification.

2017.04.30

Metal Core SMD Power Inductors for Industrial / Automotive Comfort and Safety Applications
(MCOIL™, MD series)(AEC-Q200 qualified)

MCOIL™

MDMK2020T2R2MMV



AEC-Q200 qualified

Dimension	unit : mm	unit : inch
Length :	2.0 +/- 0.15	(0.079 +/- 0.006)
Width :	2.0 +/- 0.15	(0.079 +/- 0.006)
Height :	1.2 max.	(0.047 max.)

Inductance :	2.2	uH	(test freq at 1MHz)
DC Resistance :	0.095 / 0.109	ohm	(typ / max)
Saturation Current :	2,000 / 1,750	mA	(typ / max)
Temp. rise Current :	1,550 / 1,450	mA	(typ / max)
Saturation current typical :	30% reduction from initial L value.		
Temp rise Current typical :	Temperature will rise by 40 deg C		
Maximum rated voltage :	DC 25 V		

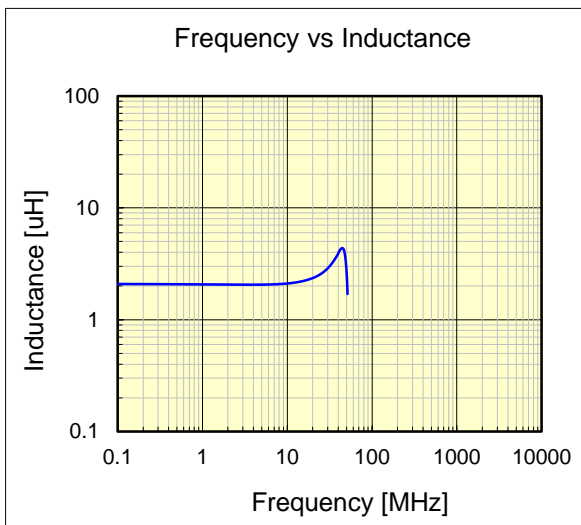
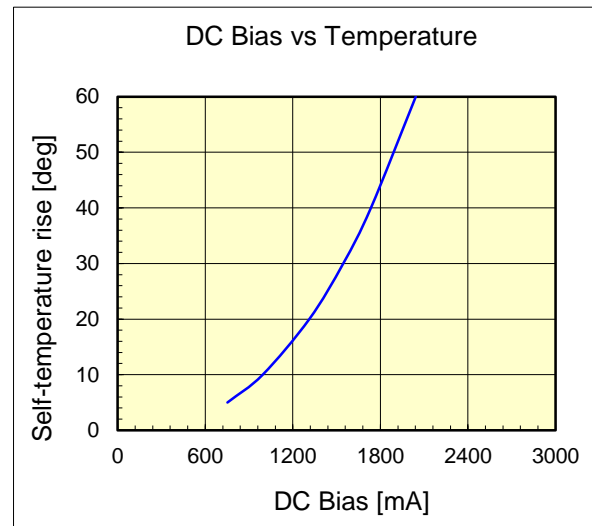
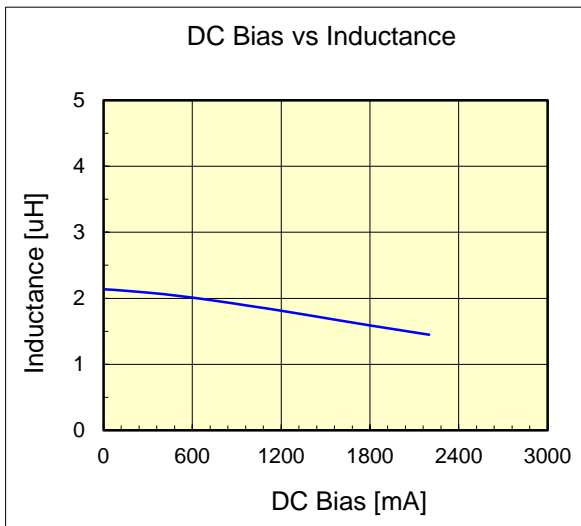

The data is reference only. Electrical characteristics vary depending on environment or measurement condition. TAIYO YUDEN reserves the right to make change to the data at any time without notice. Before making final selection, please check product specification.

The products are tested based on the test conditions and methods defined in AEC-Q200. Please consult with TAIYO YUDEN for the details of the product specification and AEC-Q200 test results, etc., and please review and approve TAIYO YUDEN's product specification before ordering.