

LOADING PATTERN MATING SIDE

|     |   |   |   |   |   |   |   |   |   |   |
|-----|---|---|---|---|---|---|---|---|---|---|
| f   | K | K | K | K | K | K | K | K | K | K |
| e   | 5 | E | E | E | E | 5 | 5 | 5 | 5 | 5 |
| d   | 5 | E | E | E | E | 5 | 5 | 5 | 5 | 5 |
| c   | 5 | 5 | 5 | 5 | 5 | 5 | 5 | 5 | 4 | 5 |
| b   | 5 | E | E | E | E | 5 | 5 | E | E | 5 |
| a   | 5 | E | E | E | E | 5 | 5 | E | E | 5 |
| z   | K | K | K | K | K | K | K | K | K | K |
| POS | 0 | 1 |   |   |   | 0 | 5 |   |   | 1 |
|     | 1 |   |   |   |   | 5 |   |   |   | 0 |

LOADED CONNECTOR ASSEMBLY  
(FOR EXAMPLE)

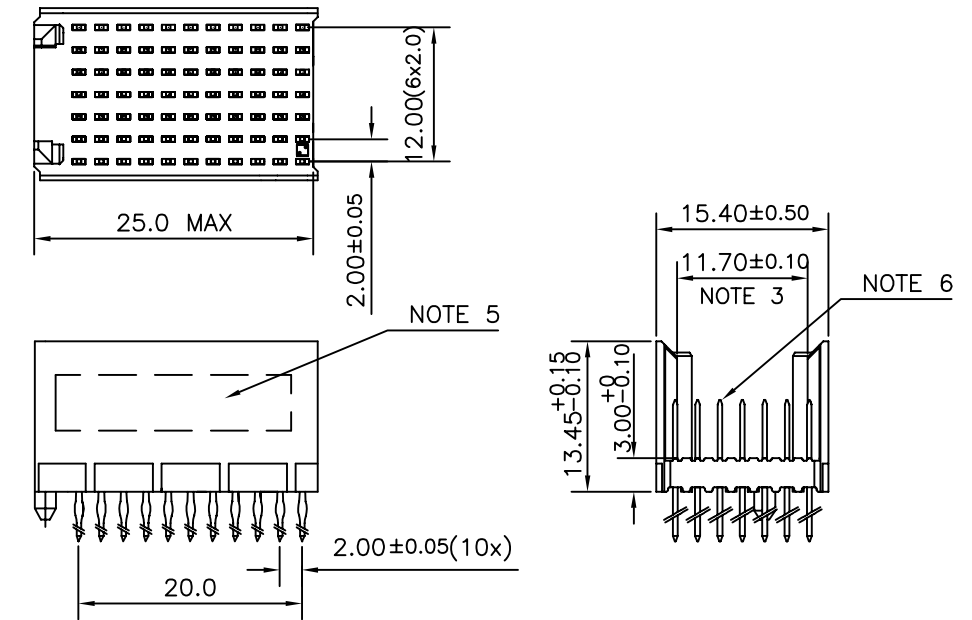

CONTACT OVERVIEW

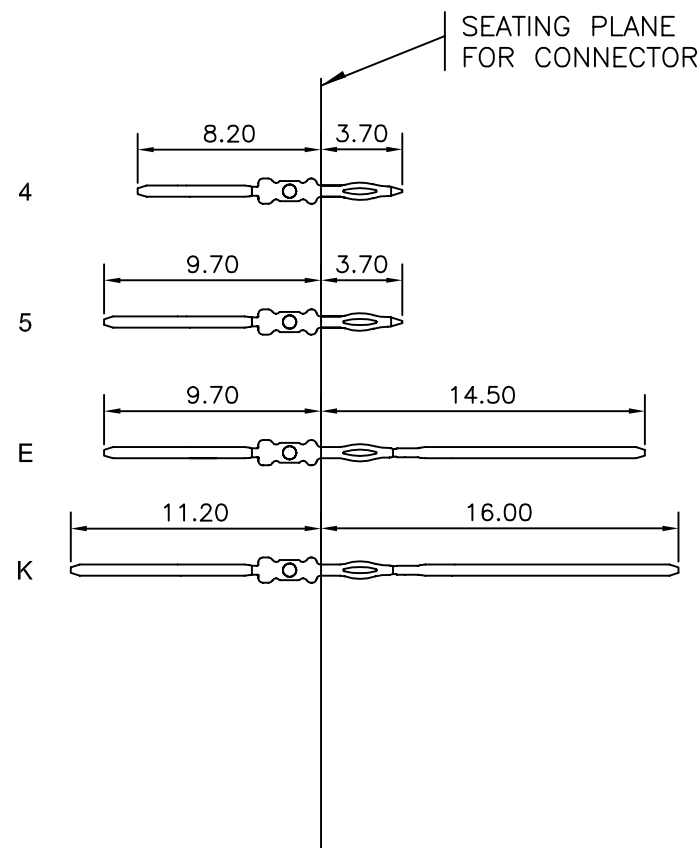

LAY-OUT P.C.B.-HOLE

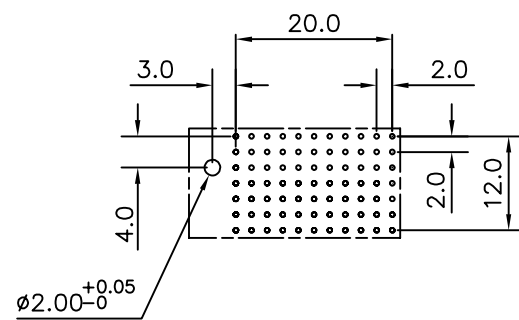

HM2P80PMA3W1 LF LEAD FREE INDICATOR : LF = LEAD FREE (DIGIT 15 & 16)

PLATING CODE (DIGIT 13 AND 14)  
(REF DRW NO. BS,C , 201844 , 003)

NOTES

- THIS PRODUCT IS CSA APPROVED.
- THIS PRODUCT IS UL RECOGNIZED.
- MEASURED AT THE BOTTOM.
- MATERIAL CONTACT: PHOSPHORBRONZE  
HOUSING: CREAM WHITE GLASS FILLED POLYESTER UL-94V0
- CONNECTOR PRINTED WITH P/N AND DATE CODE.
- FOR ACTUAL CONTACT LOADINGS, SEE LOADING PATTERN MATING SIDE.
- SHAPE OF CONNECTOR HOUSING CAN ALTER DEPENDING ON PRODUCTION LOCATION
- THE PRODUCT (LF) MEETS EUROPEAN UNION DIRECTIVES AND OTHER COUNTRY REGULATIONS AS DESCRIBED IN GS-22-008
- FOR RECOMMENDED PTH DIMENSIONS REFER DRAWING : BS, A , 201572 , 001

CATALOG NO: HM2P80PMA3W1----

|                           |          |                       |                               |                                    |                             |
|---------------------------|----------|-----------------------|-------------------------------|------------------------------------|-----------------------------|
| mat'l. code<br>SEE NOTE 4 |          | surface<br>ISO 1302 ✓ | tolerance<br>ISO 406 ISO 1101 | projection<br>                     | product family<br>MILLIPACS |
| ltr                       | ecn no   | dr                    | date                          | title                              |                             |
| A                         | 104-0019 | MINI                  | 2004/03/16                    | MPACS 5+2R STR HDR PF CONN TYPE CR |                             |
| B                         | 105-0187 | MINI                  | 2005/10/13                    | scale —                            |                             |
| C                         | 106-0090 | MINI                  | 2006/06/26                    | MM                                 |                             |
|                           |          | dr                    | MINI K VANDANATH 2004/03/16   | dwg no                             |                             |
|                           |          | enr                   | BIJU K PAUL 2004/03/16        | sheet 1 of 1                       |                             |
|                           |          | chr                   | BIJU K PAUL 2006/06/26        | size                               |                             |
|                           |          | appd                  | BIJU K PAUL 2006/06/26        | A3                                 |                             |
| sheet index               |          | revision              | c                             | type Product Customer Drawing      |                             |
| sheet                     |          | 1                     |                               |                                    |                             |